

CITIZEN®

iDP-3240

HIGH-SPEED PRINTER



iDP-3240

CITIZEN®

FEATURES

Compact design
High-speed line thermal printing
Easy paper loading
Bar-code printing
Cash drawer kick out
Compatibility with ESC/POS
Page mode
112mm page width
Bit map data registration
80 columns mode available

iDP-3240

SPECIFICATIONS

Printing method	Thermal line dot printing
Printing width	104mm / 832 dots
Dot pitch	8 x 8 dots/mm (203 dpi x 203 dpi)
Printing speed	Max. 80mm/Sec (18.9 lines/Sec.)
Number of columns	Font A - 69/80 columns Font B - 92/80 columns
Character size (W)x(H)	Font A: 1.25 x 3.00mm (12 x 24 dots) Font B: 0.88 x 3.00mm (9 x 24 dots)
Character table	Code Page 437, 850, 852, 857, 860, 863, 865,866, Katakana and Windows code
Bar-code type	UPC-A/E, JAN(EAN)-13/8, ITF, CODABAR, Code 39, Code 93 and Code 28
Line spacing	4.23mm (1/6 inch), can be set by a command
Paper	Thermal paper roll, 112mm width x .83mm
Interface	Centronics Parallel RS-232C Serial
Input buffer 64K bytes	64K bytes
NV bit map data area	256 bytes
Drawer Kick-out	2 Drawers
Power supply	Main unit: DC24V AC adapter: 31AD
AC Adapter	Input: AC100-240V, 50/60Hz, 120VA Output:DC24V, 1.9A
Weight	Main unit: 1.45kg / AC adapter: 0.45kg
External dimensions	186 (W) x 201(D) x 128 (H) mm
Operating environment	5°C ~ 40°C, 35 ~ 85% RH
Storage environment	20°C ~ 60°C, 10 ~ 90% RH
Safety standard	UL, C-UL, FCC class A, TUV, GS, CE marking

Type Classification

iDP3240 R F 230

① ② ③ ④

① Model type

3240: 112mm Wide thermal printer

② Interface

P: Parallel
R: Serial RS-232C

③ Character Set

F: International
J: Japanese

④ Power source

100: 100v
120: 230v
230: 230V

Easy paper loading

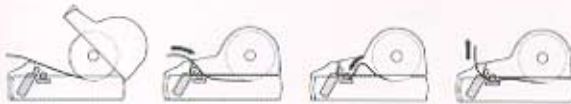

① Close the cover. (②-③ is automatic)
② Paper is fed backward.
③ Paper goes into proper position.
④ Paper is fed forward. Printer is ready to print.

CBM America Corporation

Reliability • Value • Support

365 Van Ness #510
Torrance, CA 90501
310-781-1460
310-781-9152 Fax
800-421-6516
www.cbma.com